



## DISMANTLING JOINT T-KLL (L2)

Nominal pressure:  
**PN 10**

Flange connection:  
**DIN 2632**

Hygienic cert. PZH:  
**HK/W/0041/01/2011**

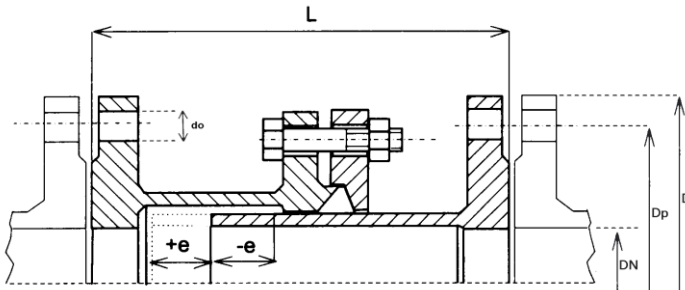

### Special material:

1.4301 = AISI 304 = 0H18N9 = A2  
 1.4401 = AISI 316 = 0H17N12M2 = A4  
 1.4541 = AISI 321 = 1H18N9T  
 1.4571 = AISI 316 Ti = 0H17N13M2T = A4

**Flange-Spigot stuffing boxes compensator T-KLL (L2)**, not lockable pieces. They compensate variation of length; allow expansion; angular movements up to 4°.

Sealing: EPDM

Material: Carbon Steel St3s (St37-2, S235 JR)

Bolts (DIN 957) and Nuts: zinc plated

Anticorrosion protection (OPTIONS):

- internally and externally coated with bitumen, admitted to contact with drinking water
- inside and outside zinc plated
- epoxy powder coating EKB (electrostatic plastic coating, according to RAL-G2662)

DN	L [mm] body length	+/-e	D [mm]	Dp [mm]	M threaded rod	i [pcs.] oty. of bolts	Weight [kg]
32	300	40	140	100	18	4	7,5
40	300	40	150	110	18	4	9
50	300	40	165	125	18	4	12
65	300	40	185	145	18	4	14
80	300	40	200	160	18	8	16
100	300	40	220	180	18	8	20
125	300	40	250	210	18	8	26
150	300	40	285	240	23	8	32
175	300	40	315	270	23	8	40
200	300	40	340	295	23	8	46
250	350	50	395	350	23	12	70
300	350	50	445	400	23	12	83
350	350	50	505	460	23	16	98
400	380	50	565	515	27	16	122
450	380	50	615	565	27	20	130
500	380	50	670	620	27	20	147
550	380	50	730	675	30	20	163
600	380	50	780	725	30	20	195
650	380	50	835	780	30	24	219
700	380	50	895	840	30	24	244
800	380	50	1015	950	33	24	304
900	390	50	1115	1050	33	28	348
1000	390	50	1230	1160	36	28	403
1100	400	50	1340	1270	36	32	480
1200	400	50	1455	1380	39	32	616
1300	400	50	1575	1490	42	32	710
1400	400	50	1675	1590	42	36	820
1500	400	50	1785	1700	42	36	923
1600	400	50	1915	1820	48	40	1055
1800	450	50	2115	2020	48	44	1320
2000	450	50	2325	2230	48	48	1740

- SPECIAL PERFORMANCE ON REQUEST -